



# 1 1/16" BORE STAINLESS STEEL CYLINDER

## USN-17-□-□

Single Acting



**Mount:** Universal    **Standard Stroke Lengths:** 1/2", 1", 1-1/2", 2", 3", 4"  
**Type:** Non-Rotating Rod    **Spring Compressed:** 7 lbs.    **Spring At Rest:** 2 lbs.  
**Options:** M, B, H, V, P6, N    **Maximum Stroke:** 27"    For M option add 0.125

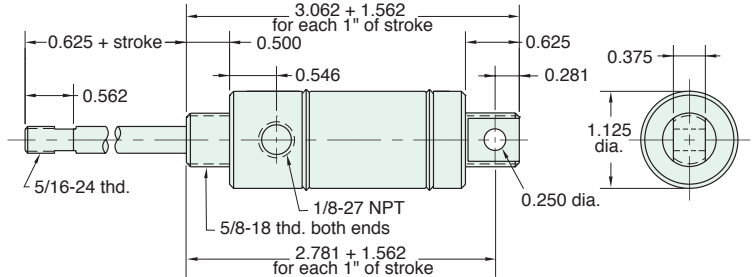

Furnished without nut(s). See Chart on Page 34.

## USR-17-□-□

Single Acting



**Mount:** Universal    **Standard Stroke Lengths:** 1/2", 1", 1-1/2", 2", 3", 4"  
**Type:** Rotating Rod    **Spring Compressed:** 7 lbs.    **Spring At Rest:** 2 lbs.  
**Options:** M, B, H, V, P6, N, W    **Maximum Stroke:** 27"    For M option add 0.125

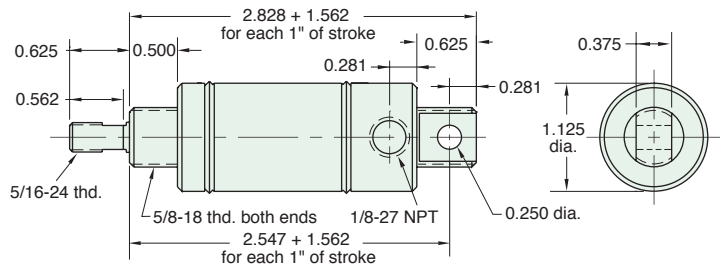

Furnished without nut(s). See Chart on Page 34.

## FDR-17-□-□

Double Acting



**Mount:** Front    **Standard Stroke Lengths:** 1/2", 1", 1-1/2", 2", 3", 4", 5", 6"  
**Type:** Rotating Rod    **Maximum Stroke:** 42"  
**Options:** M, B, W, V, P6, P7, P8, S, N    For S option add 0.250

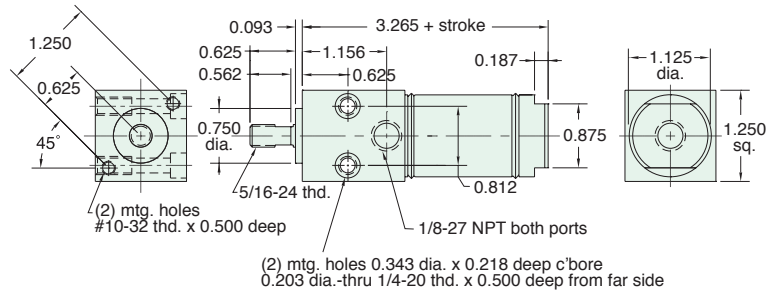

## SDR-17-□-□

Double Acting



**Mount:** Stud    **Standard Stroke Lengths:** 1/2", 1", 1-1/2", 2", 3", 4", 5", 6"  
**Type:** Rotating Rod    **Maximum Stroke:** 42"  
**Options:** C, F, R, M, B, W, V, P6, P7, P8, S, N    For C, F, R or S option add 0.250  
For CM, FM and RM add 0.562

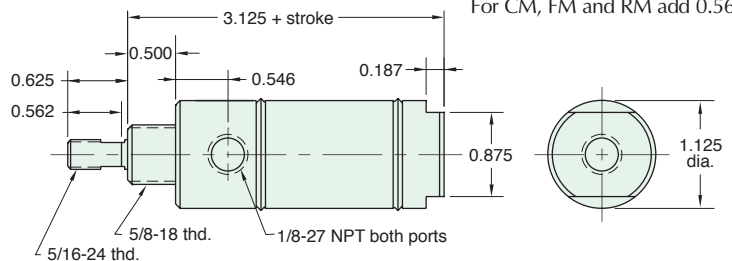

Nut included, but not shown on drawing  
C, F, & R options use side ported rear head